

COVID-19 | Instructions for teaching or care staff

Pool testing: collecting samples

The lollipop test should ideally be performed in the morning before breakfast, as the sensitivity is best then. If this is not possible, the test can also be performed after food intake with a slightly reduced sensitivity.

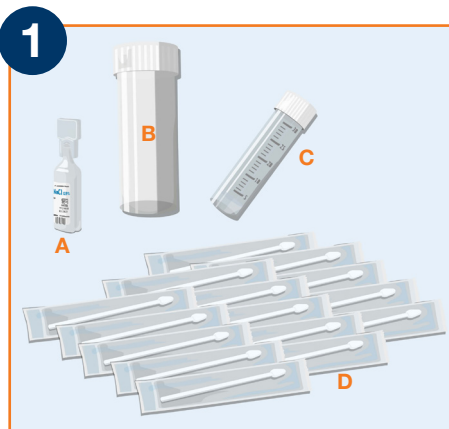

Sanitise your hands before collecting samples or wear gloves while doing so.

Check the kits content. It should include:

- **A** 1 x 10 ml vial of sodium chloride (NaCl)
- **B** 1 transport tube
- **C** 1 pooling tube
- **D** 10 swabs
- Transportation bag or box
- Barcode labels

Hand out a swab (D) to each person in each pooling group. Open the swab packet for each child by pulling back the transparent film.

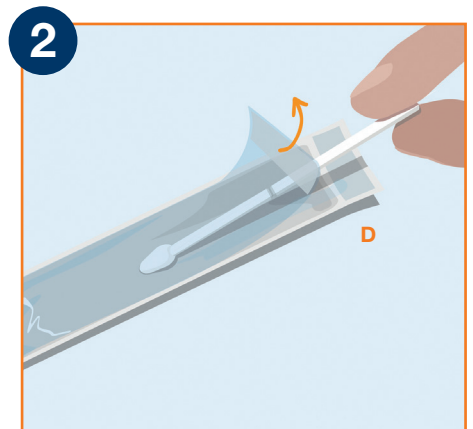

Place the end of the swab with the cotton tip in the person's mouth and ask the child to suck on it for 30 seconds, moving their tongue back and forth. **Make sure they do not chew the swab!**

After 30 seconds, ask the person to take the swab out of their mouth and hand them in to the pooling test coordinator. **Do not touch the tip of the swab!**

The pooling test coordinator then takes hold of each swab on either side of the predetermined breaking point and breaks it in two before placing it in the pooling tube (C).

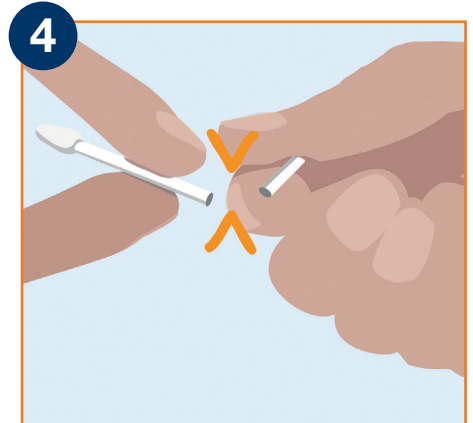



Once all the swabs have been placed in the pooling tube (C), pour the content of the sodium chloride vial (A) into the pooling tube (C) and close it carefully.

Stick the barcode label on the pooling tube (C).

The remains of the swabs and the packaging can be thrown away.

Please sanitise your hands and/or wash them thoroughly immediately afterwards!

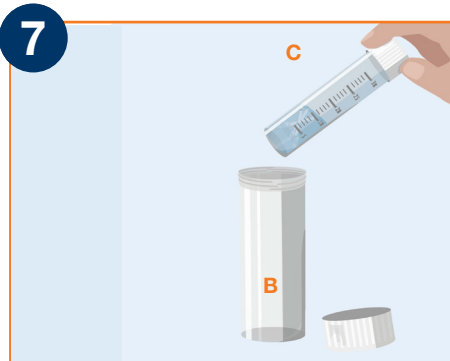
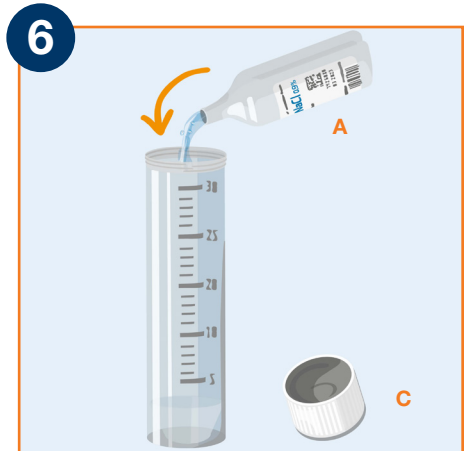

The samples are sent off in accordance with specifically defined logistical processes: the tube (C) must be placed in the transport tube (B) then either put in the bag or box provided for transport or hand it in directly at one of our centres.

